

Project Navigator, Ltd.

www.projectnavigator.com

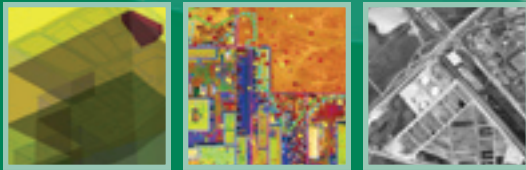

STRATEGIES INTO TACTICAL ACTION

Project Navigator, Ltd. is a knowledge, risk and resource management company. Since our inception in 1997, our project managers, engineers and scientists have developed a strong track record for creative problem solving. Our primary service is controlling the strategic direction of demanding projects.

Each project is managed to optimize our clients' interests and save money. Execution strategy is developed with seamless communication with the client.

A cornerstone of our project management approach is the use of Geographical Information System (GIS) techniques for the interpretation and analysis of project data and information. We are known for generating vivid, high quality, understandable graphics to analyze and describe complex problems.

Our GIS techniques are complemented through extensive use of the internet for transferring project information, conducting online meetings, streaming project animations to clients, and hosting onsite web cams. We have designed and currently operate www.projecttoolbox.com which is an "always on", web-enabled, project management tool. Projecttoolbox was specifically designed for online bidding and procurement, and for providing a secure project database repository for "client-only" access. This tool translates to better execution efficiency and thereby project cost savings.

Project Navigator, Ltd. is in a growth strategy of serving clients who are pursuing high-risk international projects that require the assistance of a strong, creative, project management organization. This work is being augmented through business relationships.

For more information:

Los Angeles 714.388.1800
Houston 713.468.5004

Environmentally Impacted Site Redevelopment and Brownfields

- Remedy design compatible with site development
- Superfund Brownfields initiatives
- Cost estimates for remediation and construction
- Land valuation including environmental
- Construction planning and oversight
- Project scheduling and forecasting
- Seamless integration of remedy with proposed development
- Value engineering
- Web enabled project management (www.projecttoolbox.com)
- Project construction visualization and animation
- Architectural 3D models
- Feasibility studies
- Environmental impact studies
- Data analysis via Geographical Information System (GIS) techniques
- Risk assessment and analysis
- Regulatory negotiations and strategy
- Community relations
- Bidding and procurement management

Recent Example Projects

- **WDI Superfund Site**, Santa Fe Springs, California: Oil companies project manager for \$20MM conversion of 1950's era oil field disposal site into an industrial development in the Los Angeles basin. (upper visuals)
- **PAB Oil & Chemical Superfund Site**, Abbeville, Louisiana: Strategists and project managers for oil company group who remediated this 1970's oil field production waste facility, and are developing the site into a recreational facility (soccer fields) for the local residents in a rural community. (lower right visual)
- **Tex Tin Superfund Site**, Texas City, Texas: Project Coordinator for remediation group who are performing \$20MM remedy before returning the land to industrial use, possibly as part of local container port. (lower left visual)

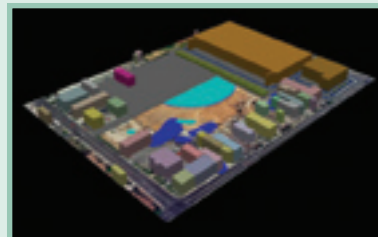

WDI



WDI



PAB



PAB