

STRATEGIES INTO TACTICAL ACTION

Project Navigator, Ltd. is a knowledge, risk and resource management company. Since our inception in 1997, our project managers, engineers and scientists have developed a strong track record for creative problem solving. Our primary service is controlling the strategic direction of demanding projects.

Each project is managed to optimize our clients' interests and save money. Execution strategy is developed with seamless communication with the client.

A cornerstone of our project management approach is the use of Geographical Information System (GIS) techniques for the interpretation and analysis of project data and information. We are known for generating vivid, high quality, understandable graphics to analyze and describe complex problems.

Our GIS techniques are complemented through extensive use of the internet for transferring project information, conducting online meetings, streaming project animations to clients, and hosting onsite web cams. We have designed and currently operate www.projecttoolbox.com which is an "always on", web-enabled, project management tool. Projecttoolbox was specifically designed for online bidding and procurement, and for providing a secure project database repository for "client-only" access. This tool translates to better execution efficiency and thereby project cost savings.

Project Navigator, Ltd. is in a growth strategy of serving clients who are pursuing high-risk international projects that require the assistance of a strong, creative, project management organization. This work is being augmented through business relationships.

For more information:

Los Angeles 714.388.1800
Houston 713.468.5004

Environmental Site Assessments

- Phase I and Phase II
- Extensive use of GIS and aerial photo interpretation techniques
- Very familiar with ASTM-E1527-97 Standard Practice for Environmental Site Assessments
- Experience with both single-site and multi-site projects
- Assessments performed for:
 - Real estate transactions
 - Insurance claim support
 - Regulatory agency response
 - Litigation support
- Phase I and II implications analysis
 - Strategy
 - Regulatory risks
 - Cost forecasting

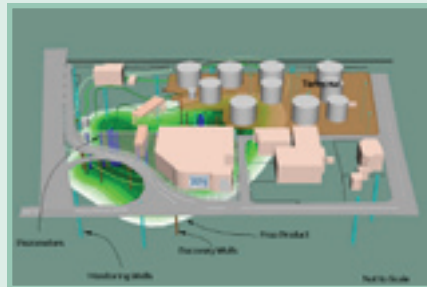

Offsite Source Analysis

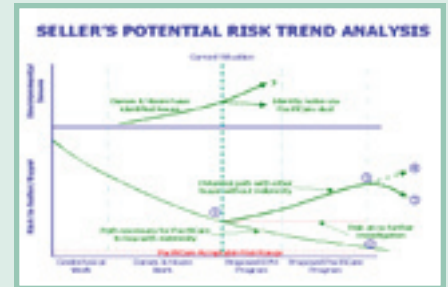

Purchase/Sale Environmental and Financial Risk Analysis

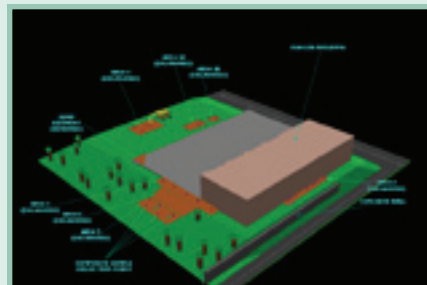

Phase I/II ESA Reports

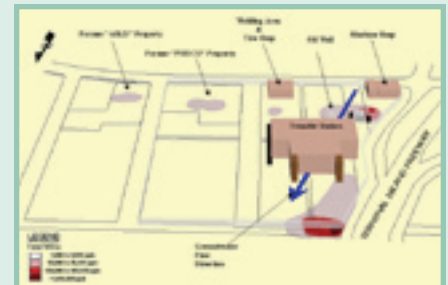

Onsite Environmental Impact Analysis

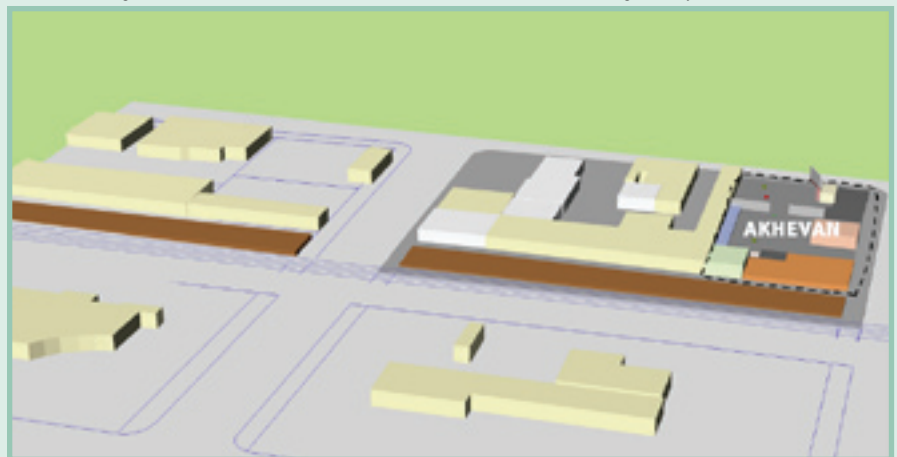

Offsite Environmental Impact Analysis